

# CALIMA

PROJECTS INC.

## CALIMA PROJECTS INC.

17 Grandview Grove  
Calgary Alberta, Canada T3Z 0A7

phone: 403-969-0654  
email: [info@calima.ca](mailto:info@calima.ca)  
website: [www.calima.ca](http://www.calima.ca)

## Composite Electrical Enclosures Model CPI-144 and CPI-144B

In today's dynamic electrical, energy and communications markets, metal fabricated enclosures often suffer from damage such as rust and corrosion. This is especially evident in harsh weather conditions and hazardous environments. Replacing outdoor panels every few years is costly and time consuming.



**CALIMA® composite enclosures offer a solution to these environmental and logistical challenges.**

**CONSTRUCTION:** composite, polymer resin + glass=extremely durable and strong. Long life span. Will not rust. Good for extreme environments.

**DESIGN:** clean and efficient, functional and stylish.

**SECURITY & MAINTENANCE:** 3-point keyed lock system.

**GASKET:** continuous neoprene closed cell seal provides excellent weather protection.

**PAINT:** Lead-free, UV-rated paint for additional protection.

**INSTALLATION:** wall mounted, pole mounted or base/wire-way mounted.

**FASTENERS:** quick install for dinrail and/or components.

**ACCESSORIES:** mounting brackets, back-pan, side-pans and shelves. Fibre and wire accessories available.

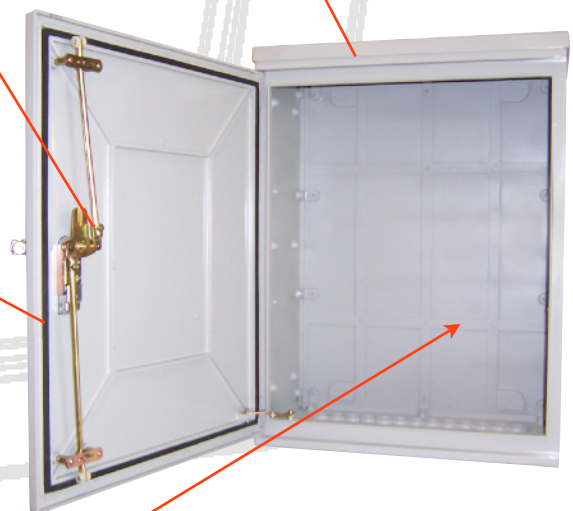

*\*Optional CPI-144B base wire-way fits below upper cabinet.*

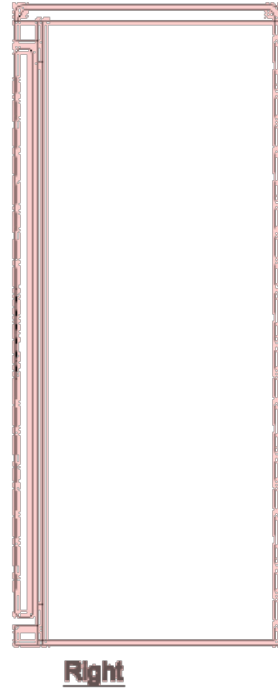
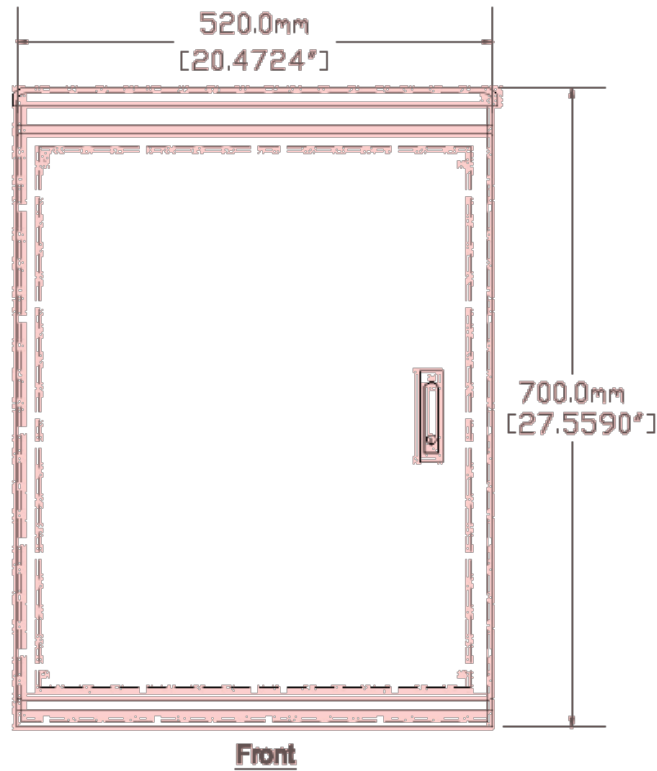
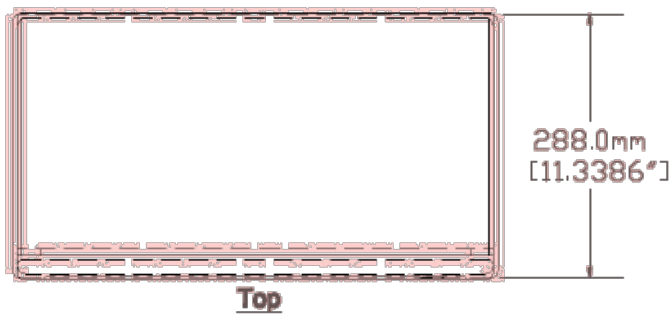

*\*Optional CPI-144B base wire way fits below the upper cabinet.*

**Specifications:**

- Rating:** Type 4X
- Grade:** GB4208-IP65
- Construction:** Polymer Resin +Glass Composite
- Flame Resistance:** FVO Level
- Environmental Temperature:** -40°C to +60°C
- Load Bearing Capacity:** Exterior >980N GEMEL<200N
- Relative Humidity:** <95% (+40°C)
- Dimensions:** L20.5"/W06.75"/H17.75"
- Metric:** L520.7mm/W171.5mm/H450.9mm



**CALIMA®** composite enclosures are manufactured to withstand extreme weather conditions. Unique molded composite forms provide **CALIMA®** enclosures with aesthetic design, strength, durability and functionality. Composite construction allows for fast easy on-site installation. Versatile mounting options allow panels to be wall mounted, pole mounted or base wire-way mounted. **CALIMA®** Composite Enclosures provide a reliable, cost-effective, long-term solution for electrical enclosure requirements.